

Welding Neck Flanges EN1092-1 Type 11B1 PN40

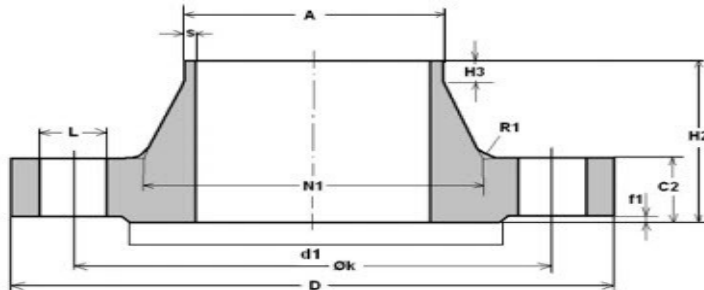

Voorlasflens EN1092-1 Type 11B1 PN40

Maatvoering	D	C2	H2	H3	S	R1	A	N1	d1	Gaten	L	K	Kg
DN 10 / 17.2 mm	90,0	16	35	6	2,0	4	17,2	28,0	40,0	4	14	60,0	0,7
DN 15 / 20.0 mm	95,0	16	38	6	2,0	4	20,0	30,0	45,0	4	14	65,0	0,8
DN 15 / 21.3 mm	95,0	16	38	6	2,0	4	21,3	32,0	45,0	4	14	65,0	0,8
DN 20 / 25.0 mm	105,0	18	40	6	2,3	4	25,0	38,0	58,0	4	14	75,0	1,1
DN 20 / 26.9 mm	105,0	18	40	6	2,3	4	26,9	40,0	58,0	4	14	75,0	1,1
DN 25 / 30.0 mm	115,0	18	40	6	2,6	4	30,0	42,0	68,0	4	14	85,0	1,3
DN 25 / 33.7 mm	115,0	18	40	6	2,6	4	33,7	46,0	68,0	4	14	85,0	1,3
DN 32 / 38.0 mm	140,0	18	42	6	2,6	6	38,0	52,0	78,0	4	18	100,0	1,9
DN 32 / 42.4 mm	140,0	18	42	6	2,6	6	42,4	56,0	78,0	4	18	100,0	1,9
DN 40 / 44.5 mm	150,0	18	45	7	2,6	6	44,5	60,0	88,0	4	18	110,0	2,2
DN 40 / 48.3 mm	150,0	18	45	7	2,6	6	48,3	64,0	88,0	4	18	110,0	2,2
DN 50 / 57.0 mm	165,0	20	48	8	2,9	6	57,0	72,0	102,0	4	18	125,0	2,9
DN 50 / 60.3 mm	165,0	20	48	8	2,9	6	60,3	75,0	102,0	4	18	125,0	2,9
DN 65 / 76.1 mm	185,0	22	52	10	2,9	6	76,1	90,0	122,0	8	18	145,0	3,7
DN 80 / 88.9 mm	200,0	24	58	12	3,2	8	88,9	105,0	138,0	8	18	160,0	4,8
DN 100 / 114.3 mm	235,0	24	65	12	3,6	8	114,3	134,0	162,0	8	22	190,0	6,5
DN 125 / 139.7 mm	270,0	26	68	12	4,0	8	139,7	162,0	188,0	8	26	220,0	8,9
DN 150 / 168.3 mm	300,0	28	75	12	4,5	10	168,3	192,0	218,0	8	26	250,0	11,7
DN 200 / 219.1 mm	375,0	34	88	16	6,3	10	219,1	244,0	285,0	12	30	320,0	21,0
DN 250 / 273.0 mm	450,0	38	105	18	7,1	12	273,0	306,0	345,0	12	33	385,0	34,2
DN 300 / 323.9 mm	515,0	42	115	18	8,0	12	323,9	362,0	410,0	16	33	450,0	47,6
DN 350 / 355.6 mm	580,0	46	125	20	8,8	12	355,6	408,0	465,0	16	36	510,0	69,3
DN 400 / 406.4 mm	660,0	50	135	20	11,0	12	406,4	462,0	535,0	16	39	585,0	98,0
DN 450 / 457.2 mm	685,0	57	135	20	12,5	12	457,2	500,0	560,0	20	39	610,0	105,0
DN 500 / 508.0 mm	755,0	57	140	20	14,2	12	508,0	562,0	615,0	20	42	670,0	130,0
DN 600 / 609.6 mm	890,0	72	150	20	16,0	12	609,6	666,0	735,0	20	48	795,0	209,0